

REPLACEMENT PARTS SUITABLE FOR Thermal Dynamics®

PCH/M-51

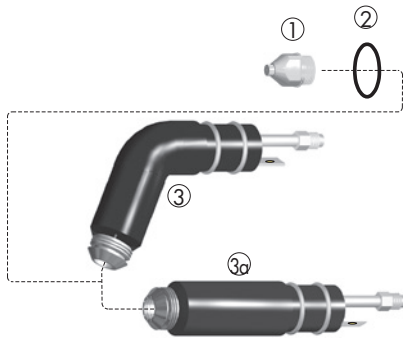

ACCESSORIES



Item	Part No.	Ref. No.	Description	Std. Pkg.	Item	Part No.	Ref. No.	Description	Std. Pkg.
1.	T-0148	9-5631	Tip, .043	10	3.	T-0152	9-5635	TMT-51, Hand Torch	1
NS	T-0150	9-5633	Electrode	10	3a.	T-0156	9-5634	TMT-51, Machine Torch	1
2.	T-0151	8-5525	O-Ring	10					

ACCESSORIES

Item	Part No.	Ref. No.	Description	Std. Pkg.	Item	Part No.	Ref. No.	Description	Std. Pkg.
1.	T-1040	9-5636-1	Handle with Switch	1	3.	T-0161	8-4204	Bushing	1
2.	T-0159	8-5005	Mounting Tube	1					

PCH/M-52

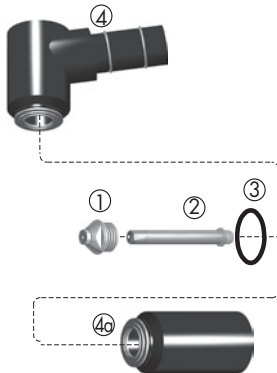

ACCESSORIES

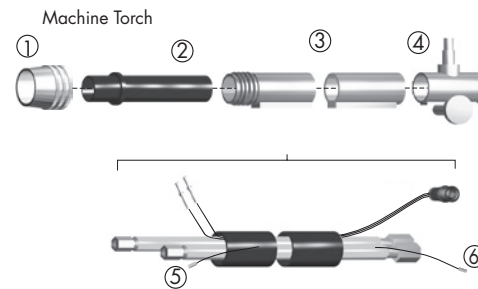

Item	Part No.	Ref. No.	Description	Std. Pkg.	Item	Part No.	Ref. No.	Description	Std. Pkg.
1.	T-0170	9-5708	Tip, .059, 100 Amp	10	3.	T-0151	8-5525	O-Ring	10
	T-0172	9-5618	Tip, .043, 45 Amp	10	4.	T-0178	9-5642	TMT-52, Hand Torch	1
2.	T-0176	9-5619	Electrode, Air	10	4a.	T-0179	9-5643	TMT-52, Machine Torch	1

ACCESSORIES

Item	Part No.	Ref. No.	Description	Std. Pkg.	Item	Part No.	Ref. No.	Description	Std. Pkg.
1.	T-0157	8-4018	Nut	1	5.	T-0914	8-4190	Fitting (-), Torch End	1
2.	T-0183	9-1901	Adapter	1		T-0976	8-5085	Ferrule	1
3.	T-0159	8-5005	Mounting Tube	1		T-0889	8-5013	Ferrule	1
4.	T-0160	7-2827 OEM	Pinion Assembly	1	6.	T-0924	8-7033	Fitting (-), Console End	1

Last update of this page: 11/11/2018. See Revision history for details.

THERMACUT®
THE CUTTING COMPANY™

WWW.THERMACUT.CZ
TEL.: +420 556 423 418
SALES@THERMACUT.CZ

WWW.THERMACUT.DE
TEL.: +49 (0) 27 39 40 33 0
INFO@THERMACUT.DE

WWW.THERMACUT.COM
TEL.: 1-603-542-6715
CUSTOMERSERVICE@THERMACUT.COM

THERMACUT®, THE CUTTING COMPANY®, FHT-EX®, EX-TRAFIRE®, EX-TRACK® AND EX-TRABEAM® ARE REGISTERED TRADEMARKS OF THERMACUT, K.S. AND MAY BE REGISTERED IN CZECH REPUBLIC AND/OR OTHER COUNTRIES. ALL OTHER TRADEMARKS ARE PROPERTIES OF THEIR RESPECTIVE OWNERS. THERMACUT IS NO WAY AFFILIATED WITH Thermal Dynamics®. MOST THERMACUT PARTS ARE MADE FOR OR BY AN IBG COMPANY. PARTS INDICATED WITH A OEM ARE ORIGINAL PARTS MANUFACTURED BY THE ABOVE NAMED MANUFACTURER AND ARE BEING RESOLD BY THERMACUT. THERMACUT RESERVES THE RIGHT TO SUBSTITUTE OEM PARTS IN PLACE OF THERMACUT PARTS. VALID FROM NOVEMBER 2018 • PREVIOUS VERSION IS NO LONGER VALID. • © COPYRIGHT 2018 BY THERMACUT® CZECH REPUBLIC. ALL RIGHTS RESERVED.